



132 Pierpont Avenue, Garden Level  
 Salt Lake City, UT 84101  
 info@ore.design | 801.936.0499  
[ore.design](http://ore.design)

## 🔊 SPEAKERS

**OPTION DESCRIPTION:** The Ore Speaker option utilizes a compact two-way speaker designed for exceptional performance. Our speakers are formed of weather-resistant construction for year-round indoor/outdoor use. Inner & outer box construction allows access to speakers for maintenance without relocating containers or removing plantings. Our Project Managers are on hand to discuss which applications are best suited to your project.

Please note that this type of installation is compatible with other functional options such as irrigation sleeves, drainage fittings, casters, and adjustable feet. To determine which containers are compatible with our Speaker option, look for this icon in our catalog and specification sheets.



**SPEAKER** | Shown in Column in Standard Powder Coat Red and Cube in Metallic Silver

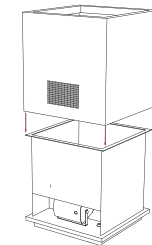
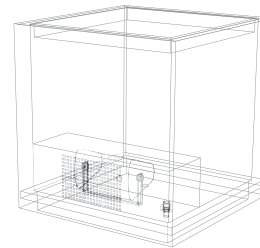
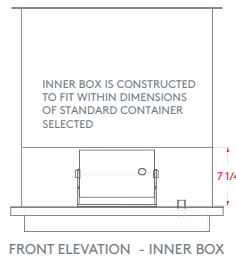
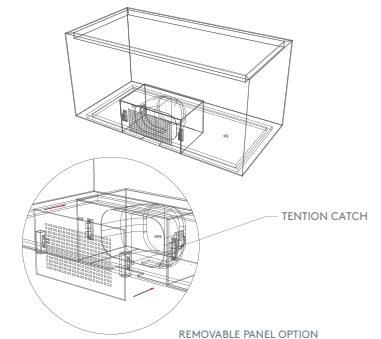
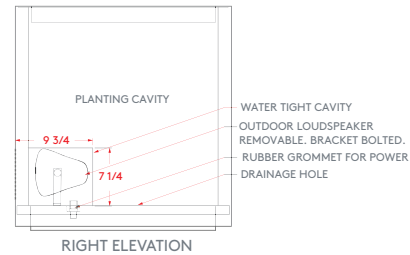
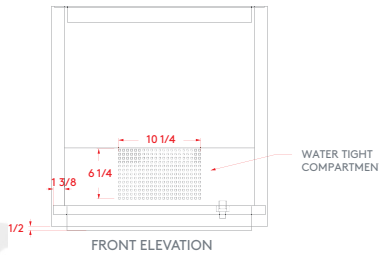

REMOVABLE SLEEVE OPTION



### ORE SPEAKER SPECIFICATIONS:

Power Rating (RMS): 100 Watts  
 Tweeter Size: 1" (25mm)  
 Depth: 5-<sup>7</sup>/<sub>8</sub>" (148mm)

Frequency Response: 85Hz – 20kHz (±3db)  
 Height: 10-<sup>3</sup>/<sub>16</sub>" (258mm)  
 Conforms to 100HR salt spray test per ASTM B117.

Woofer Size: 5-<sup>1</sup>/<sub>4</sub>"  
 Width: 6-<sup>7</sup>/<sub>8</sub>" (175mm)

### LEGAL INFORMATION:

ALL RIGHTS RESERVED. INFORMATION IN THIS DOCUMENT IS CONFIDENTIAL AND IS EXCLUSIVE PROPERTY OF ORE INCORPORATED. DELIVERY OF THIS DOCUMENT OR ANY COPY THEREOF OR DISCLOSURE OF SUCH INFORMATION TO UNAUTHORIZED PERSONS IS FORBIDDEN WITHOUT EXPRESSED WRITTEN PERMISSION OF ORE INC.

